



Portfolio

Suchismita Gangopadhyay
3rd Year Architecture Student

Email: sugangop@syr.edu
Tel: (908) 295-9848
Web: suchismitag.com



Table of Contents



Creative Living + Office Unified 3

Project Research 9

Blau House Documentation 13

South Side Market 19

Onondaga Lake Community Center 27

Forest of Columns 31

Additional Work 35

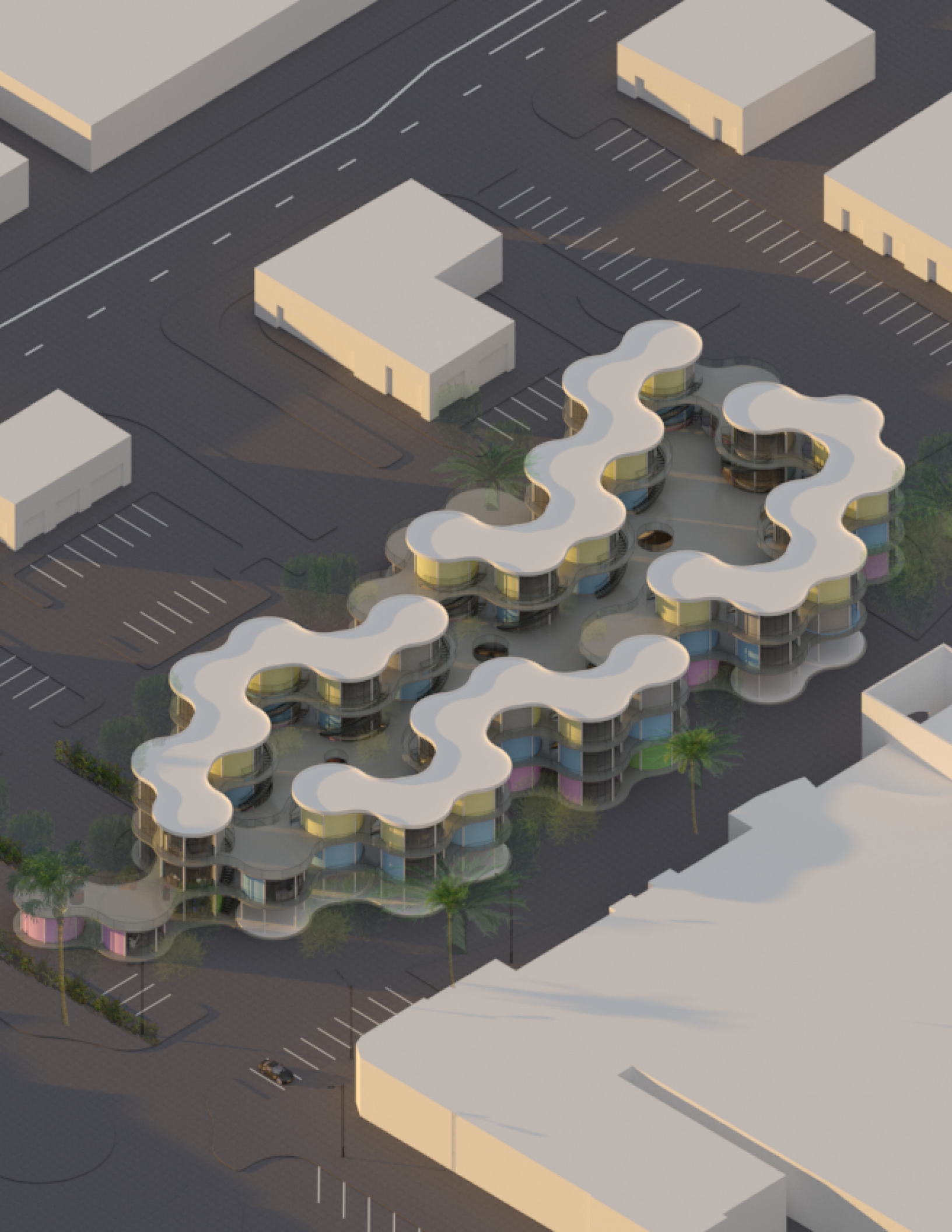

Creative Living + Office Unified

This project aims to bring living and working space into one by using a pod system that keeps the size of these spaces the same regardless of living or working so that all needs are met without needing to leave the building. This also includes having indoor/outdoor spaces and ways to collaborate and separate each space by will so the space works in and out of a pandemic, as well as improving upon the current day spaces that those who want to balance their lives.

Collaboration with Anderson Yang and Kexin Wang
Produced for ARC 307 - Abingo Wu

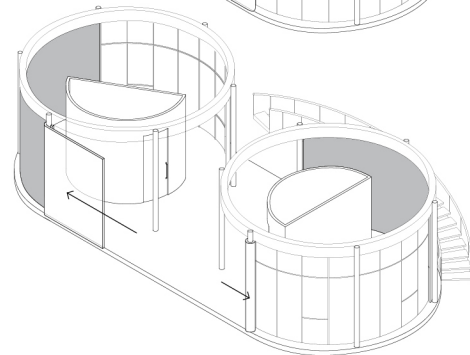
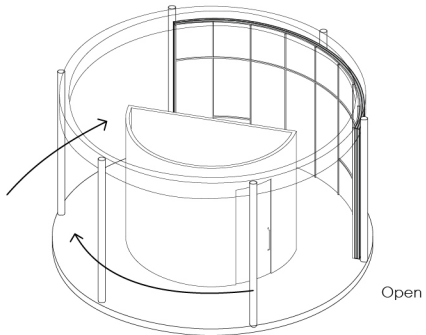
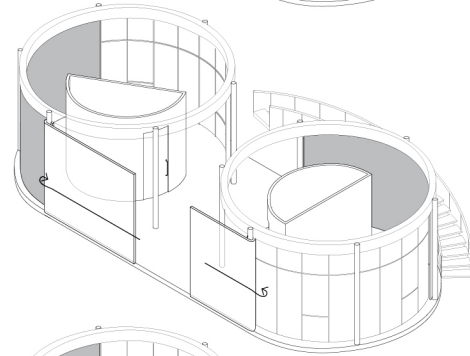
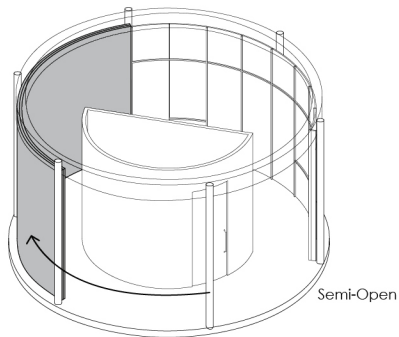
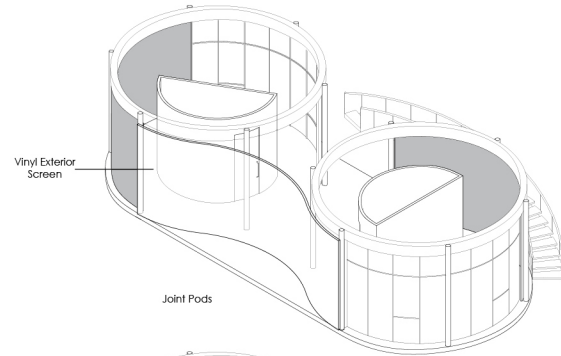
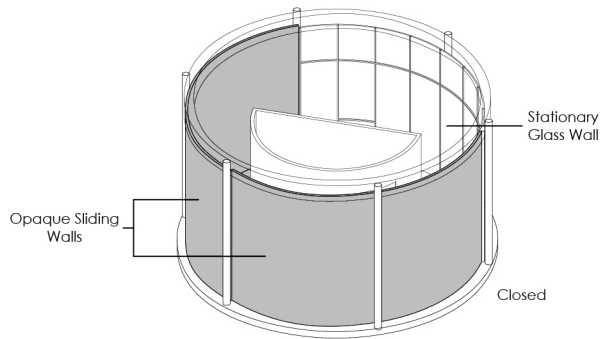
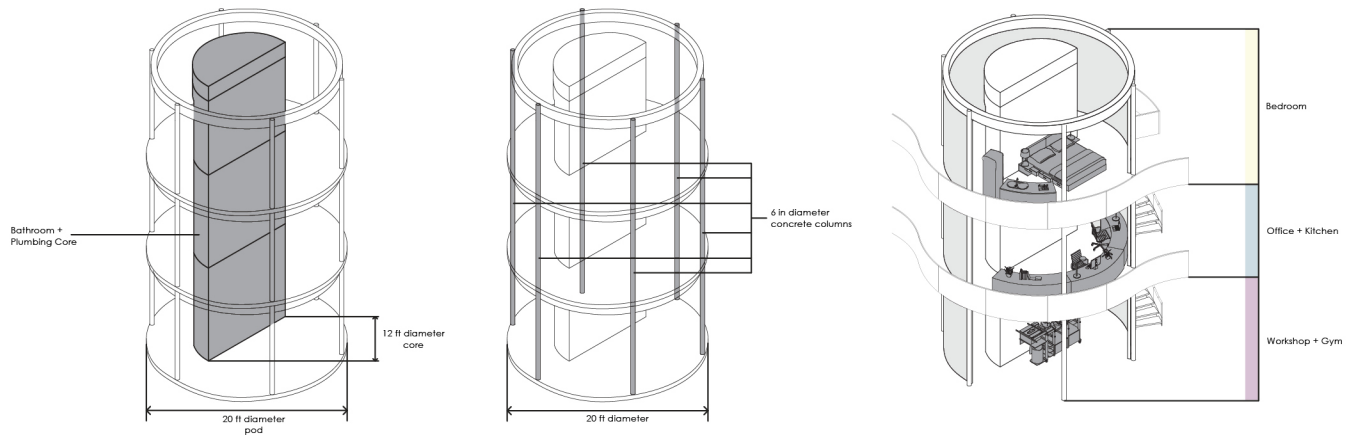

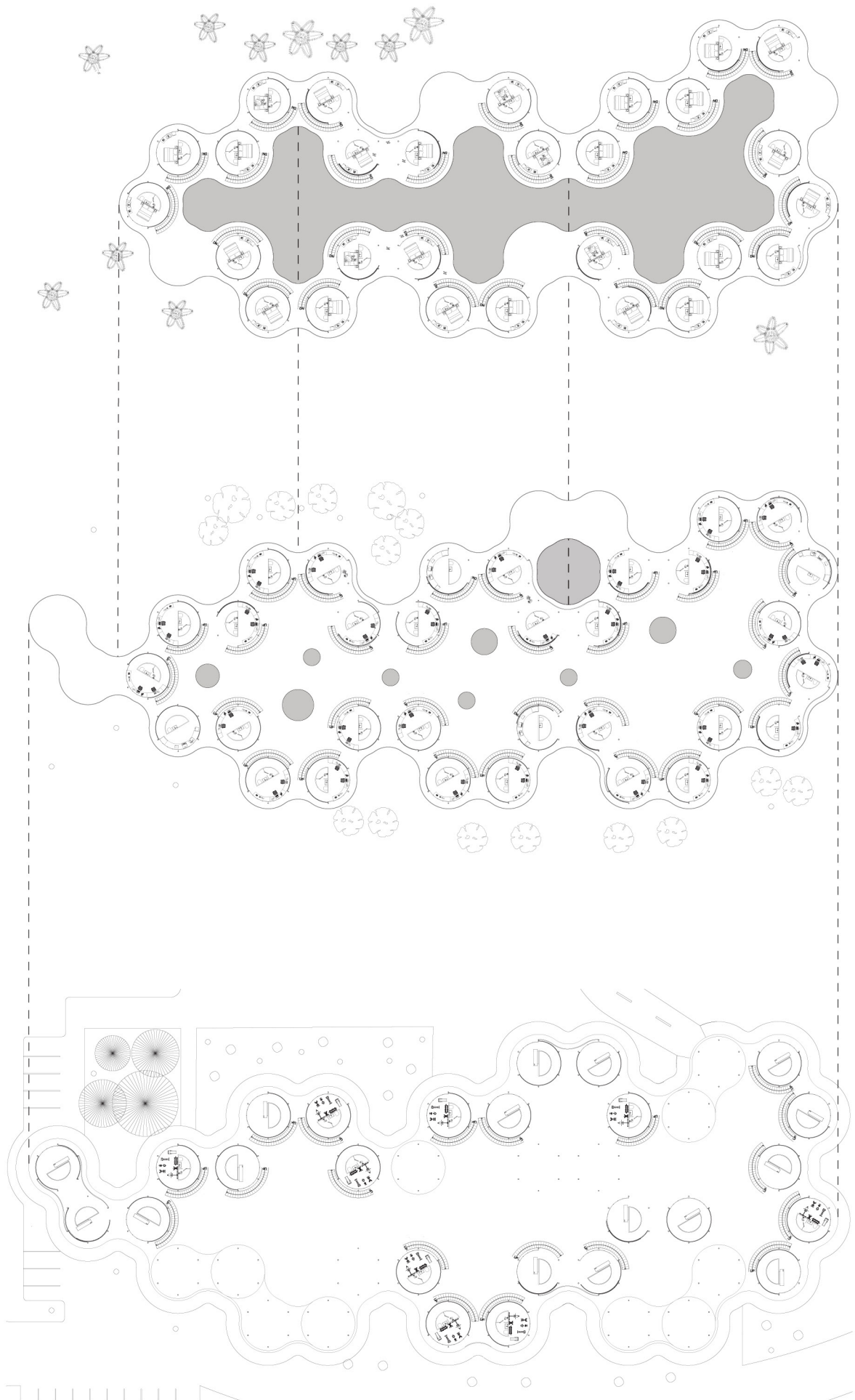

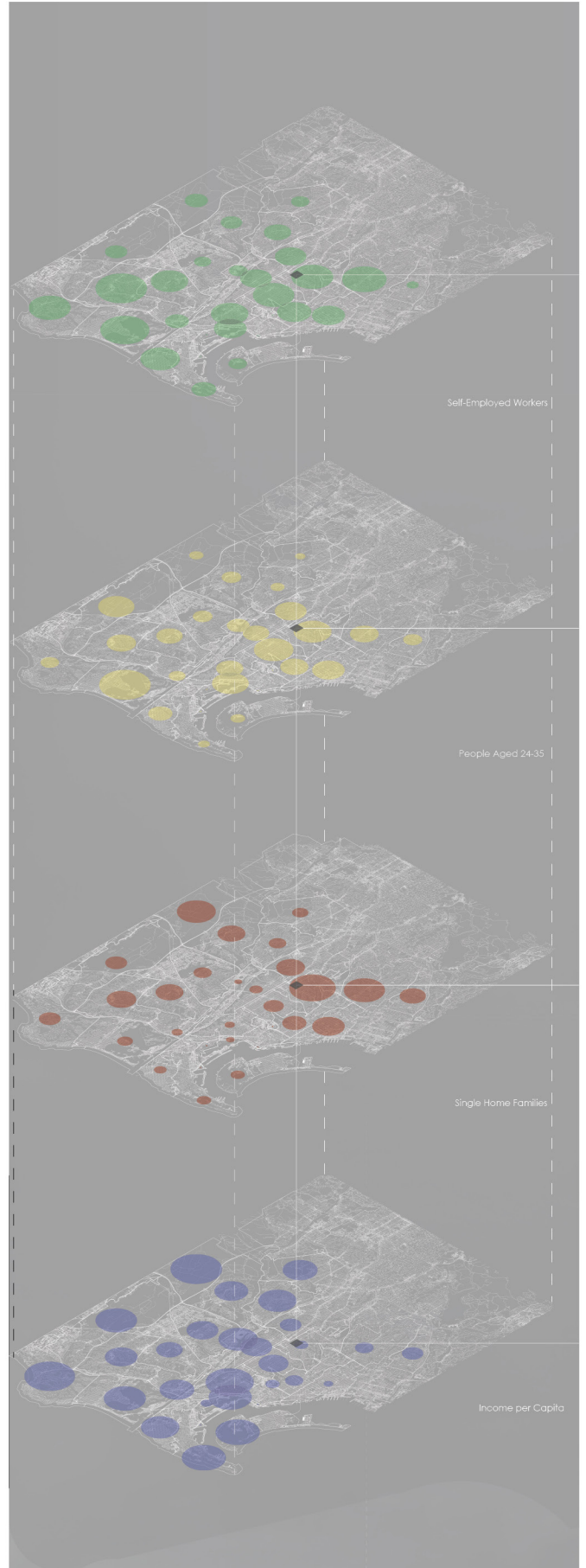
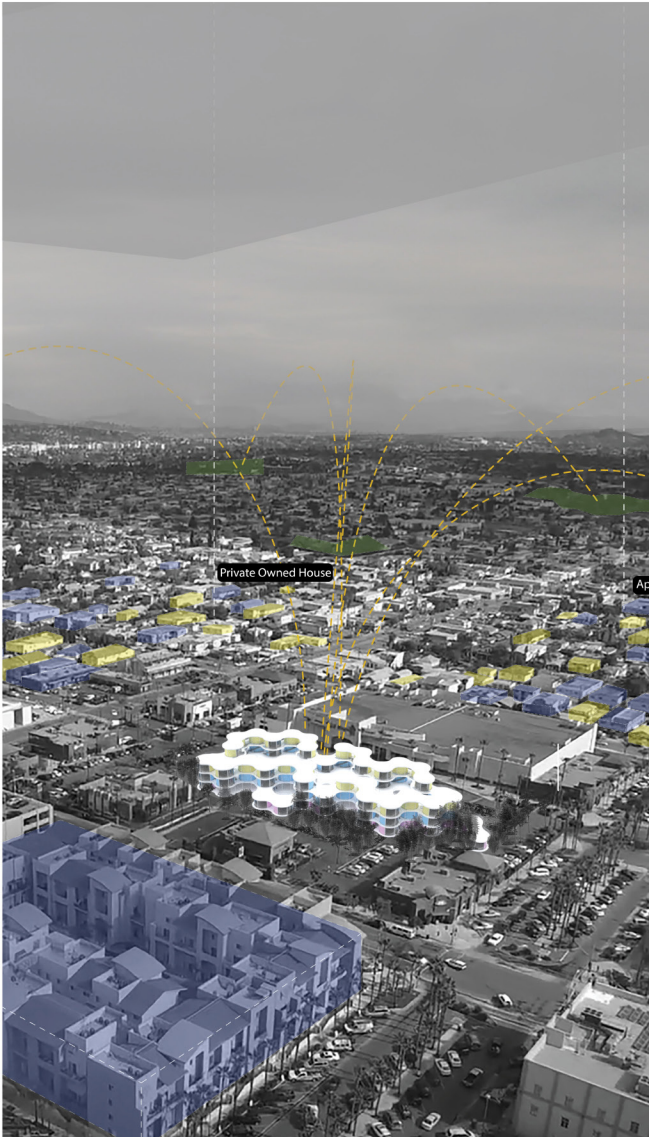

This project aims to bring living and working space into one by using a pod system that keeps the size of these spaces the same regardless of living or working so that all needs are met without needing to leave the building. This also includes having indoor/outdoor spaces and ways to collaborate and separate each space by will so the space works in and out of a pandemic, as well as improving upon the current day spaces that those who want to balance their lives.

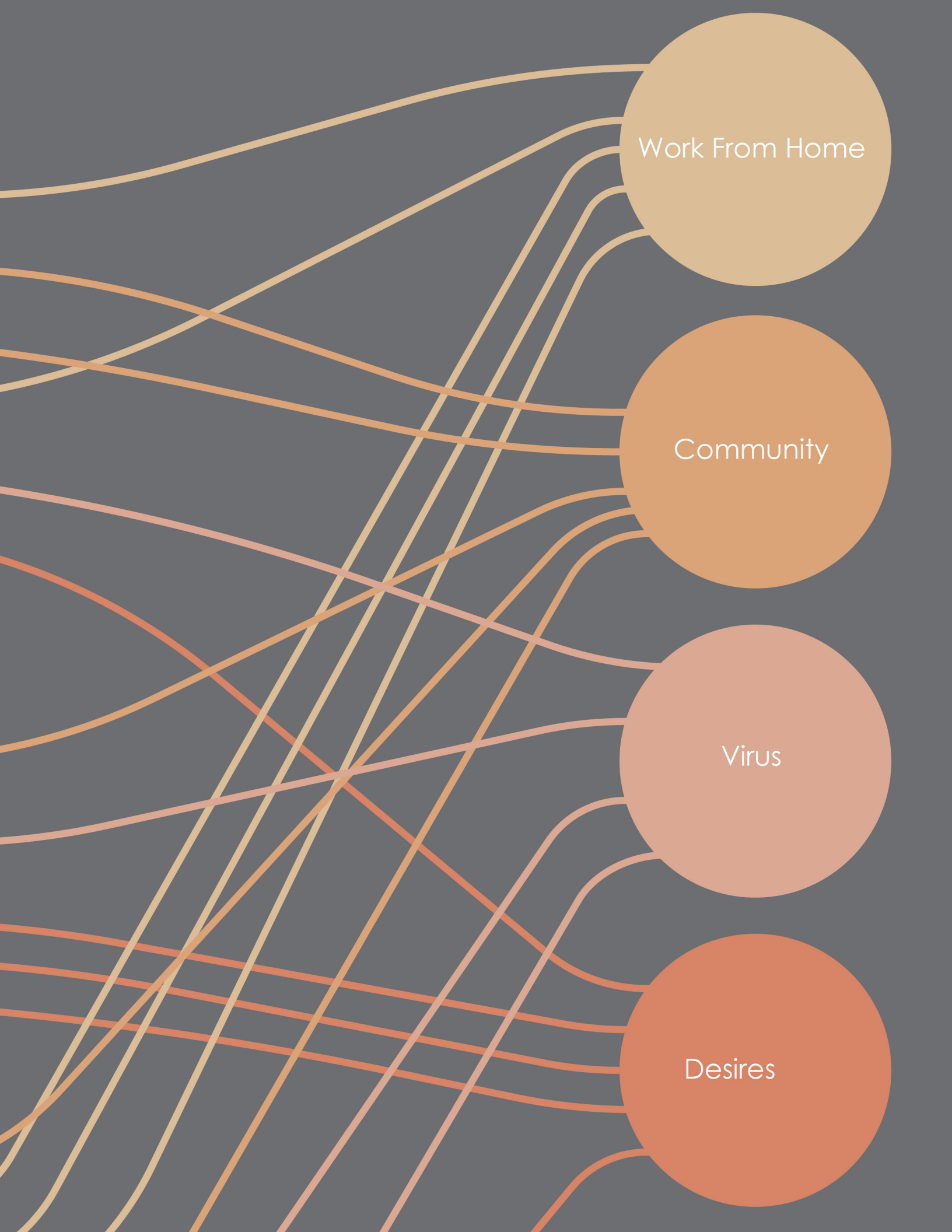

Project Research

These infographics were created to present research used to inform and explain design decisions for multiple projects. They display various information about public opinion, demographics, and many other considerations in a full design.

Produced for ARC 307 - Abingo Wu

Co-Working

Co-working is the use of a shared office space by those who are self-employed or who have different employers to collaborate and share resources.

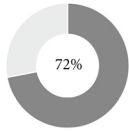

of Landlords think that working with co-working operators brings **positive** results

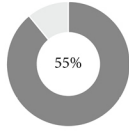

of members of co-working teams say they are **happier** with their jobs

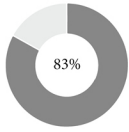

of those working in co-working hubs say they feel **less lonely**

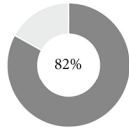

of individuals working in co-working spaces have **increased their social networks**

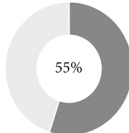

of co-workers feel like they are part of a **community**



COVID-19

Due to the outbreak of COVID-19, the co-working space experienced a drop in the number of people working from their space.

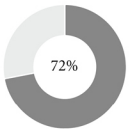

of spaces experienced a **drop** in the number of people working from their space

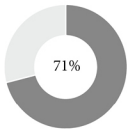

have experienced event **cancellations**

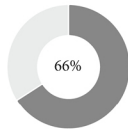

of co-working spaces have experienced **conference from**

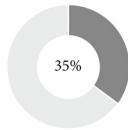

of spaces have reported **sick** members

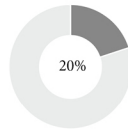

of co-working spaces have **closed**

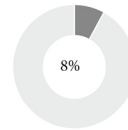

have experienced **membership cancellations**

Work From Home

39.6% of people have the problem of **working remotely**
 25.1% of people feel **lonely and depressive**
 18.6% of people need to **take care of their children**
 14% of people do not have a **private working space**

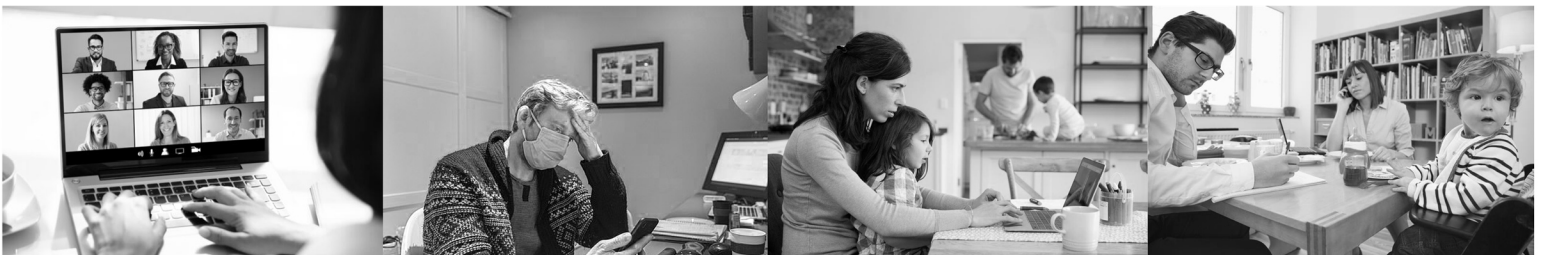

Freelance Workers

Number of American workers who freelance

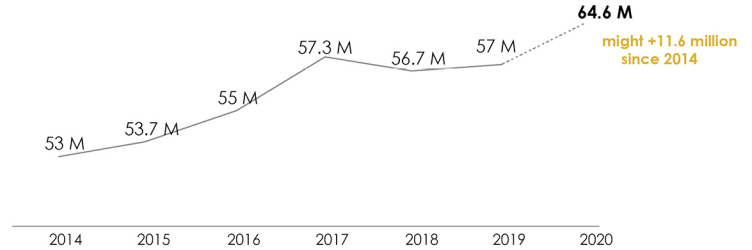

35% of Americans work freelance and the number of those who chose to work freelance has risen since the early 2000s.

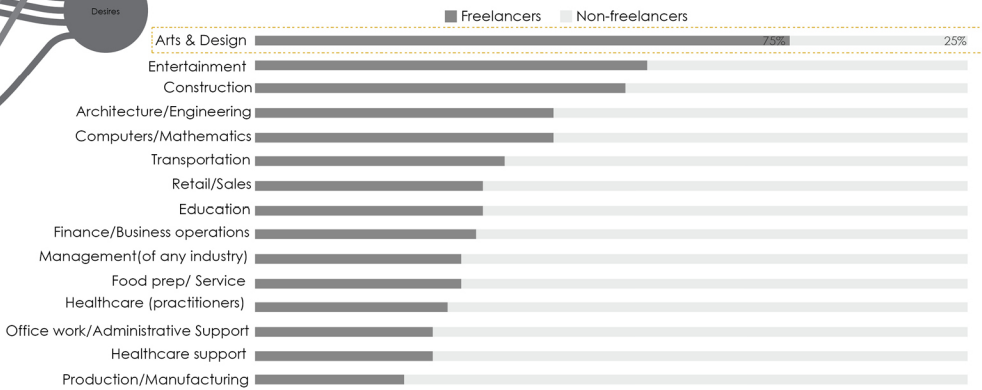

Interview



Case Study #1: Public Housing, Melbourne

[Building Isolation]

Among the first populations and buildings to lock down in Australia were Assisted Aged Living care facilities and Public Housing towers. These types of apartment buildings have many people living in close proximity. As an Australian health official puts it, these apartment buildings are like vertical cruise ships. There is a high chance of COVID-19 spread in these buildings especially because they do not have adequate ventilation systems. Additionally the residents living within these towers in Melbourne are part of the low income population so the lockdown affects them strongly.

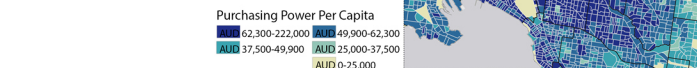

The government of Victoria immediately placed the residents of public housing tower 33 Alfred St on mandatory and strict lockdown. Residents were not to leave their residences even to buy grocery essentials as a result of the high potential for COVID-19 spread within their housing. Many residents were negatively affected by this and weren't even informed of this mandate until a lot of police had showed up outside of the apartment building to restrict movement.



The government set out with good intentions to help the residents by providing meals and incentives to residents to stay on lockdown. However the meals and aid fell short, and many residents still went without necessary resources and meals.



As a result of this lockdown and the lack of aid many residents are getting, they are experiencing a change in attitude and many view the lockdown as a jail sentence. These residents wonder what they have done wrong because they can not even go to the grocery store, while other housing developments can travel in a 5km radius of their residence.



Many people have stepped up to help out and volunteer groups have been coming together to provide food and aid for those locked down and affected by the lockdown. A lot of these volunteer groups are minorities that are trying to take care of their communities.





Blau House Documentation

For this internship I photographed, documented and created drawings for the Blau House for consideration on the National Register of Historic Places.

Produced for Robert Cohen Architect LLC

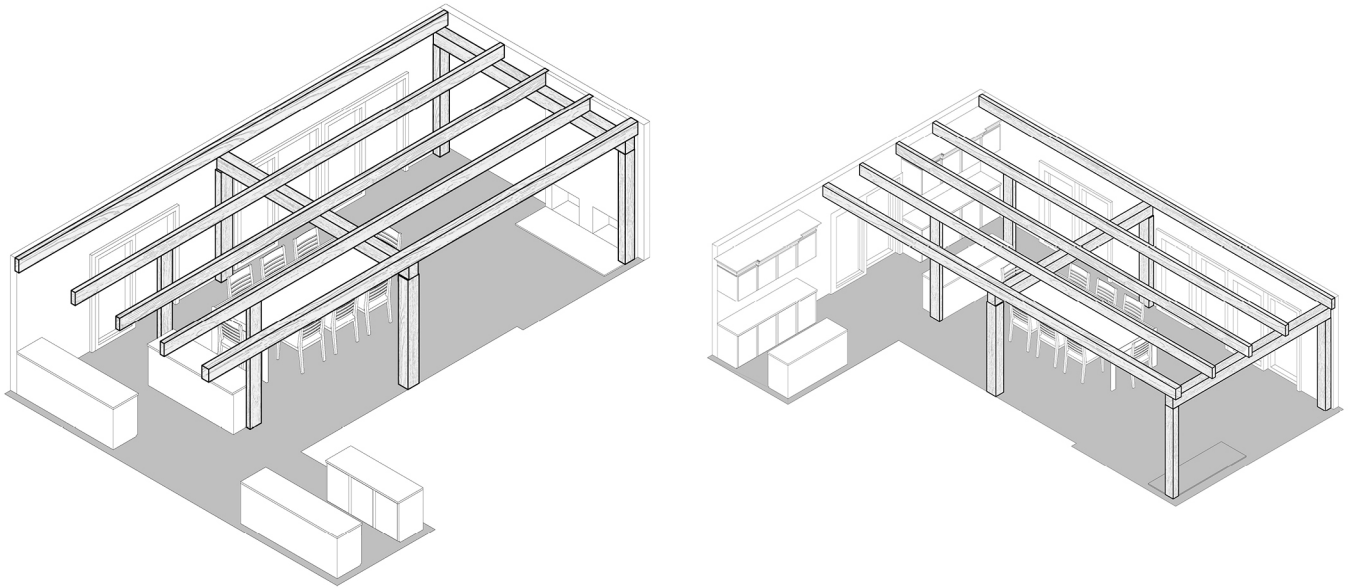

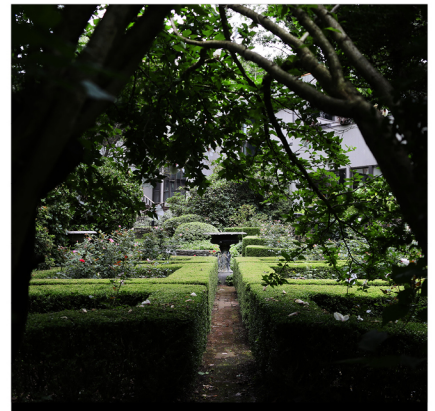

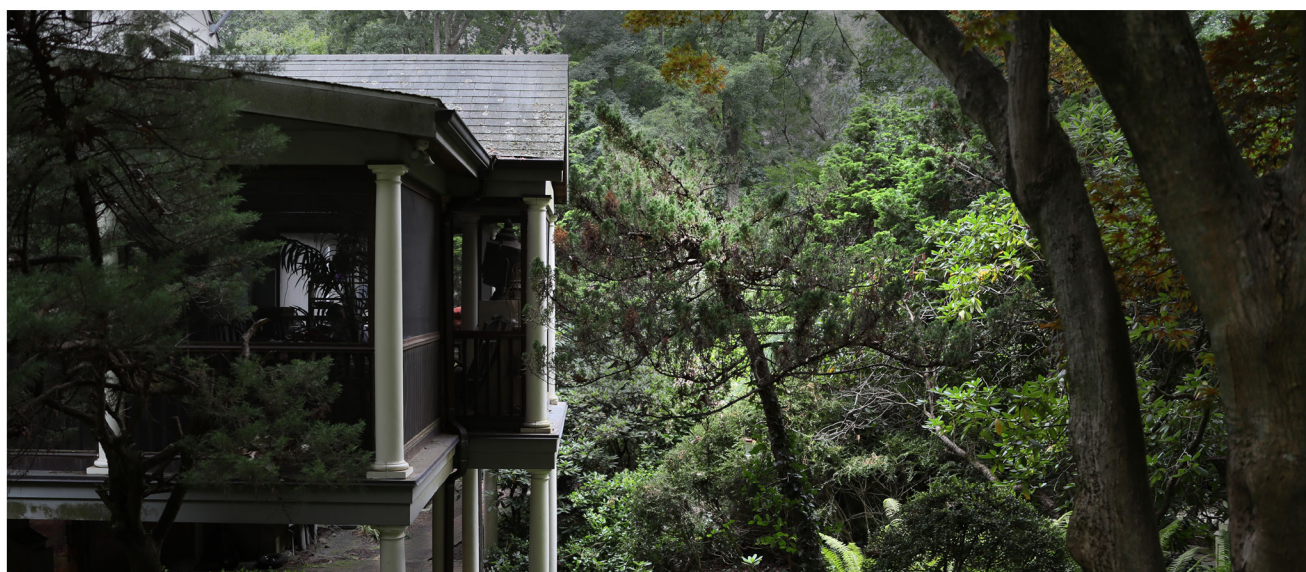

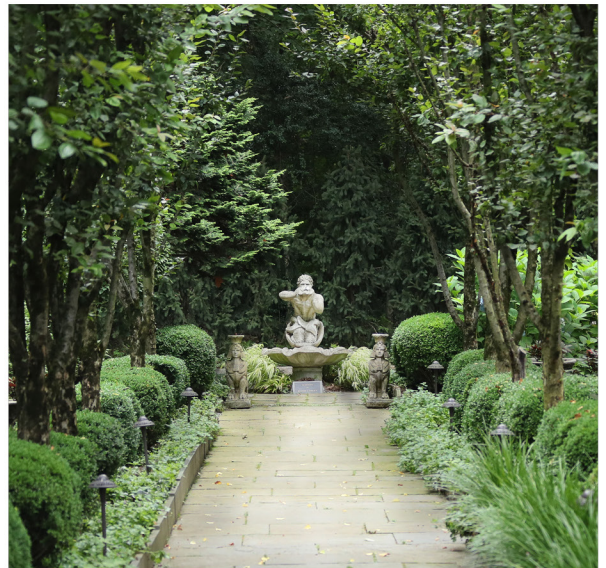

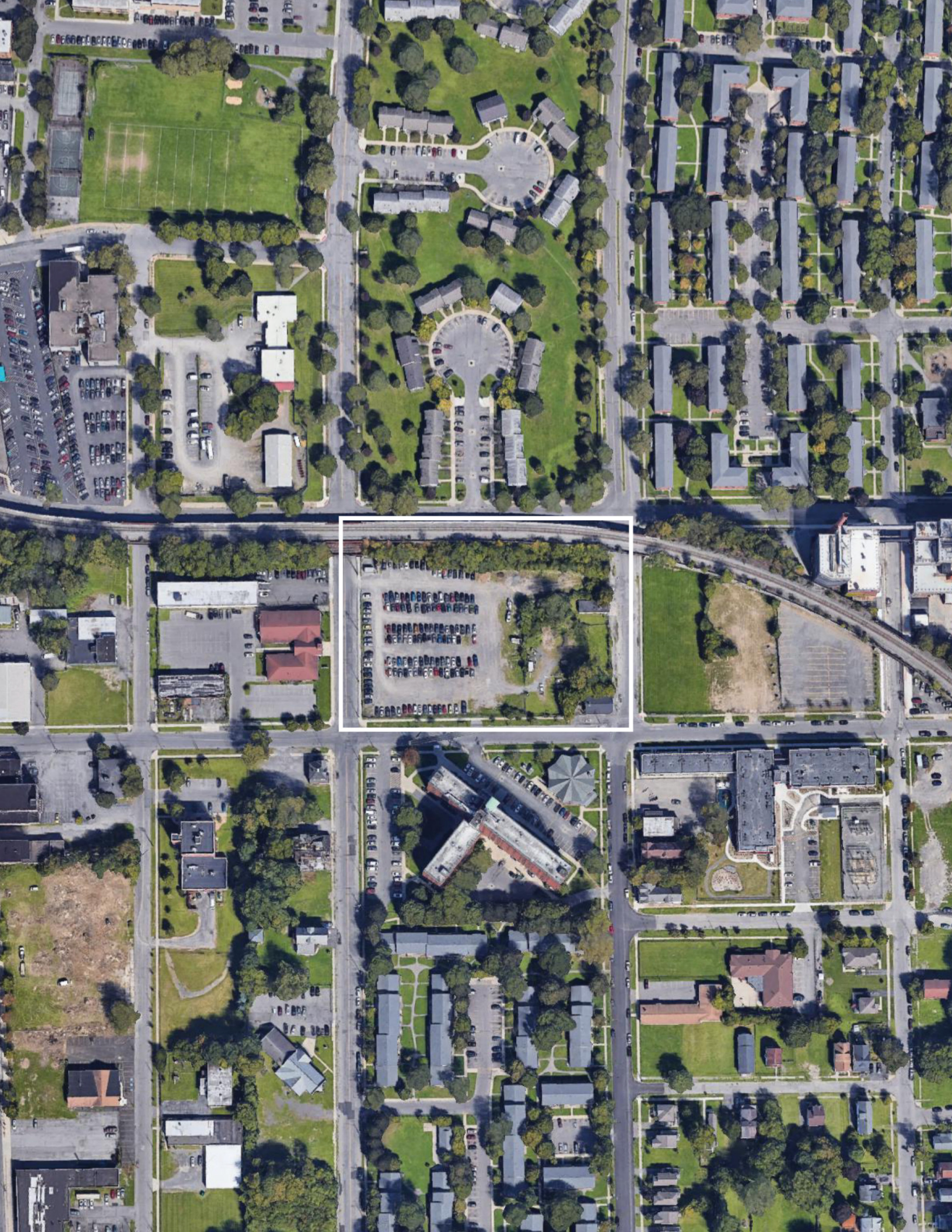

South Side Market

A series of collapsable pods that can be rearranged to accomodate different programs on the site. The site includes a few stationary community spaces, as well as many pods where individual businesses can create a storefront. This project aims to stimulate the area of South Side Syracuse.

Produced for ARC 208 - Sou Fang

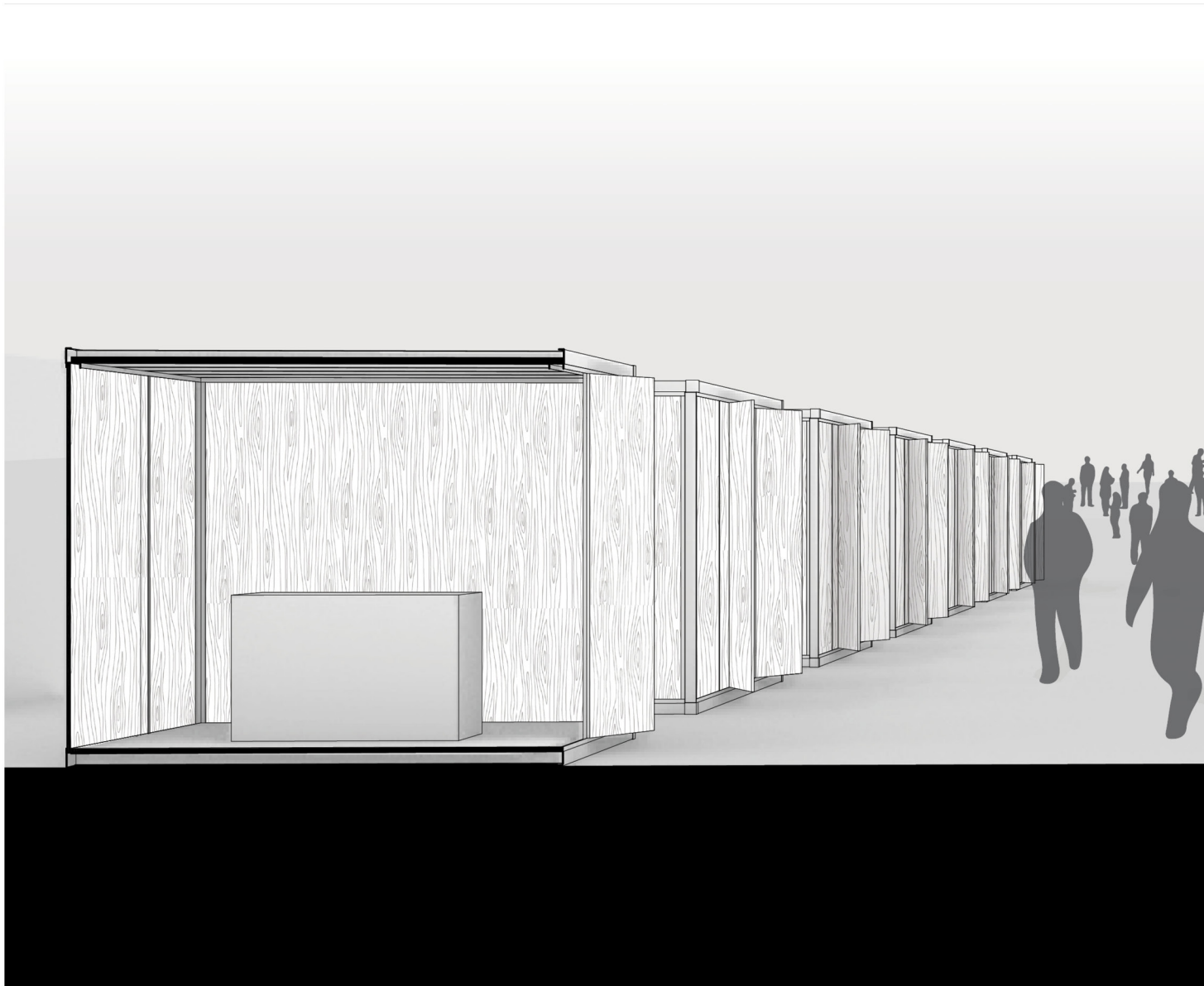

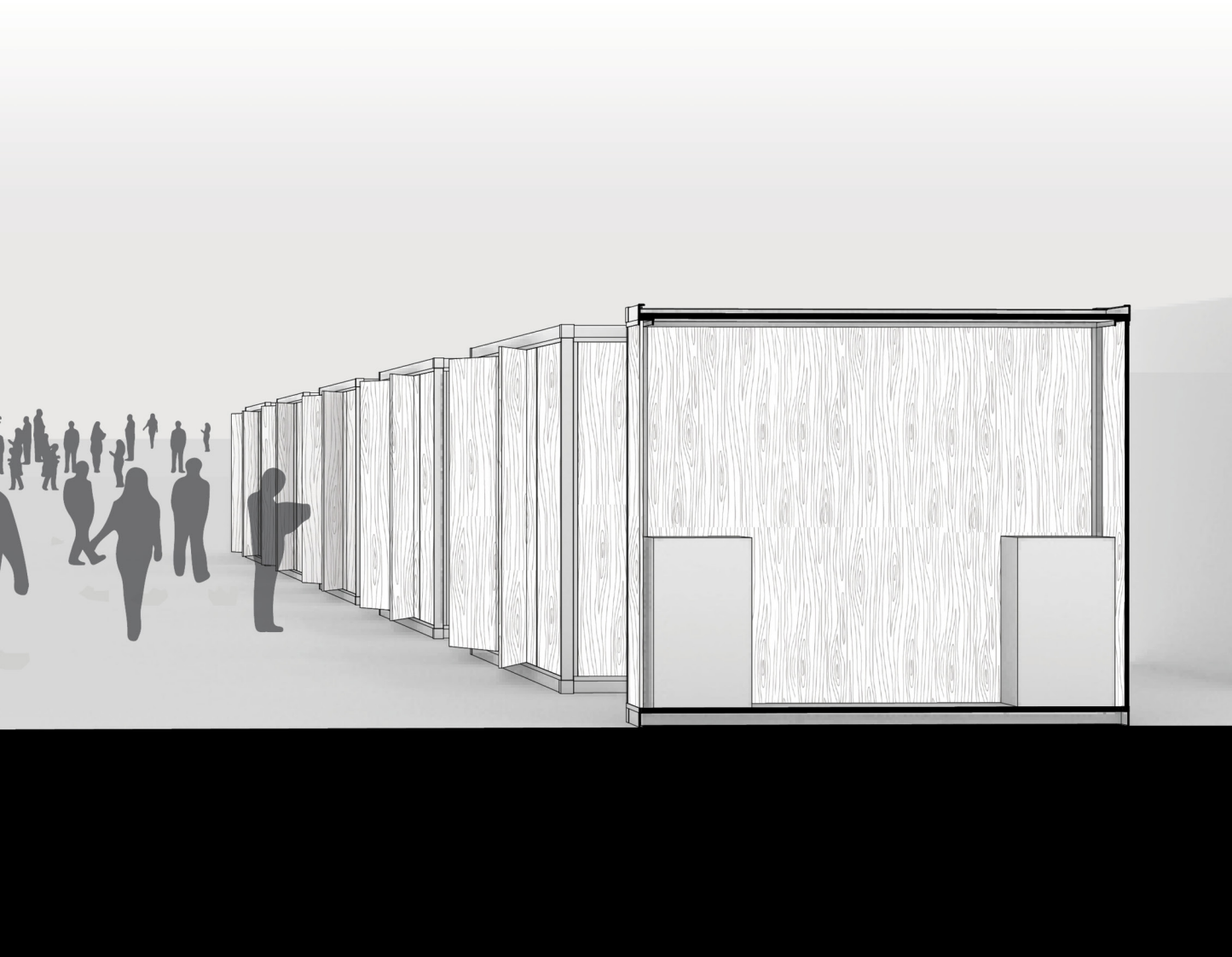

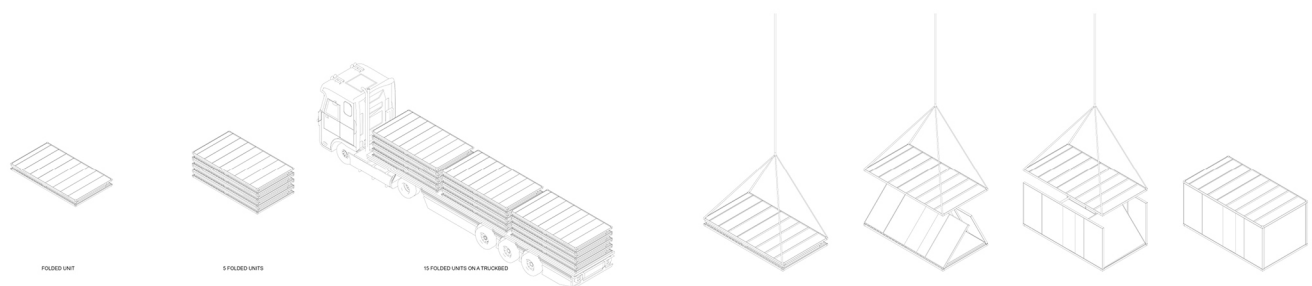
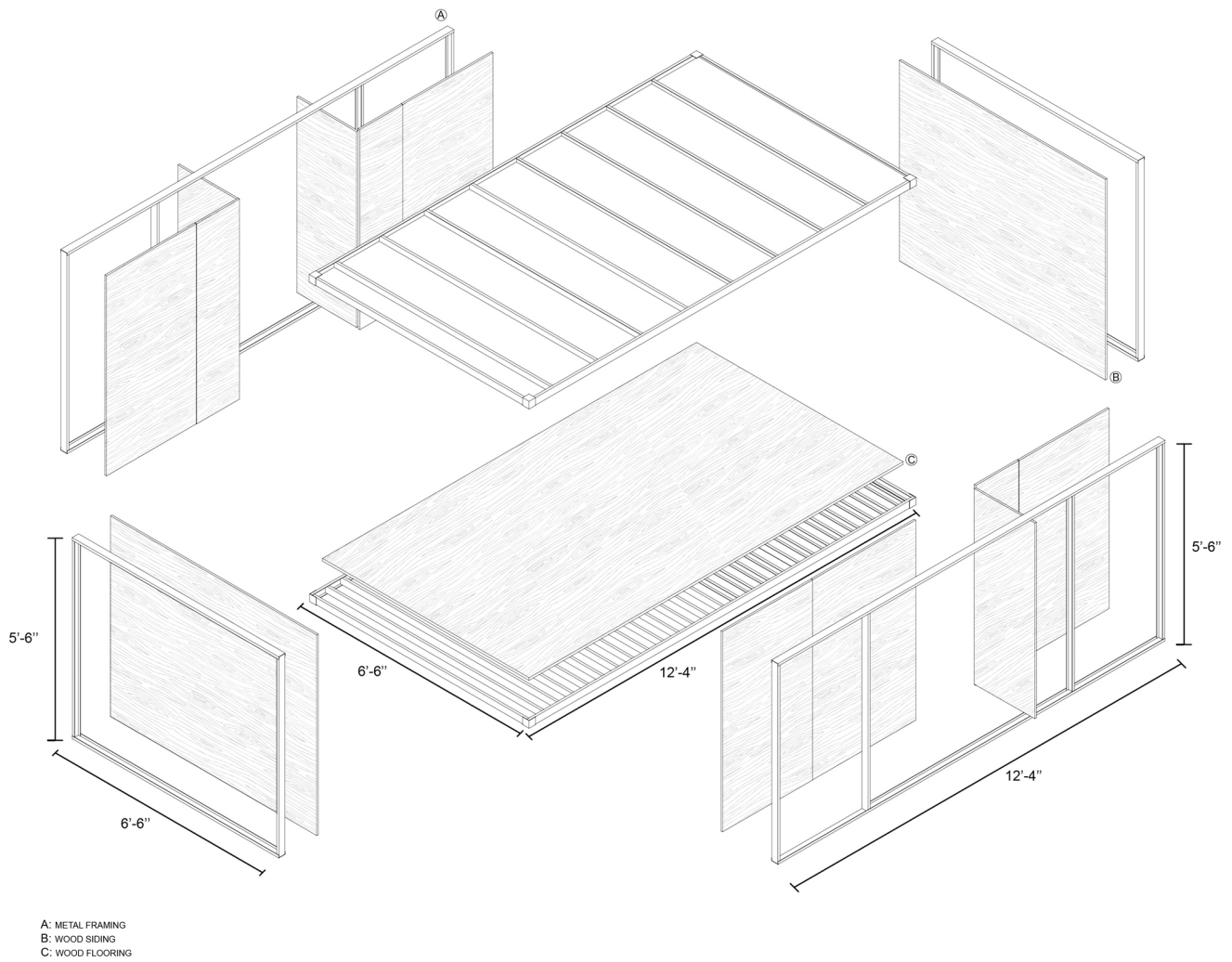

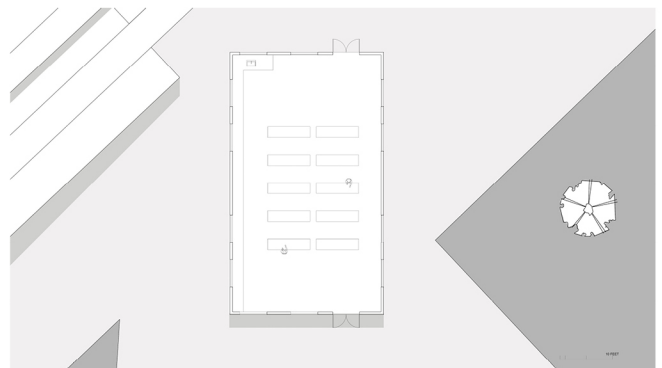
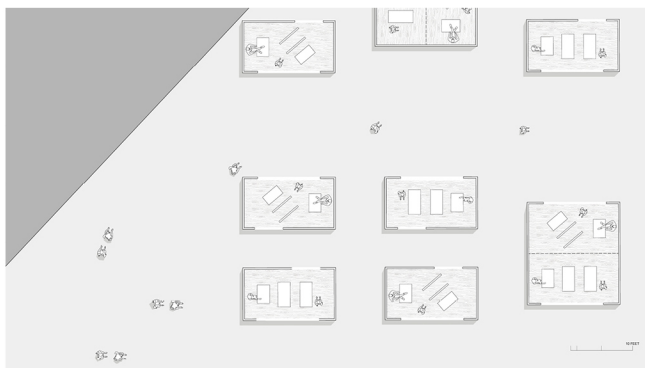
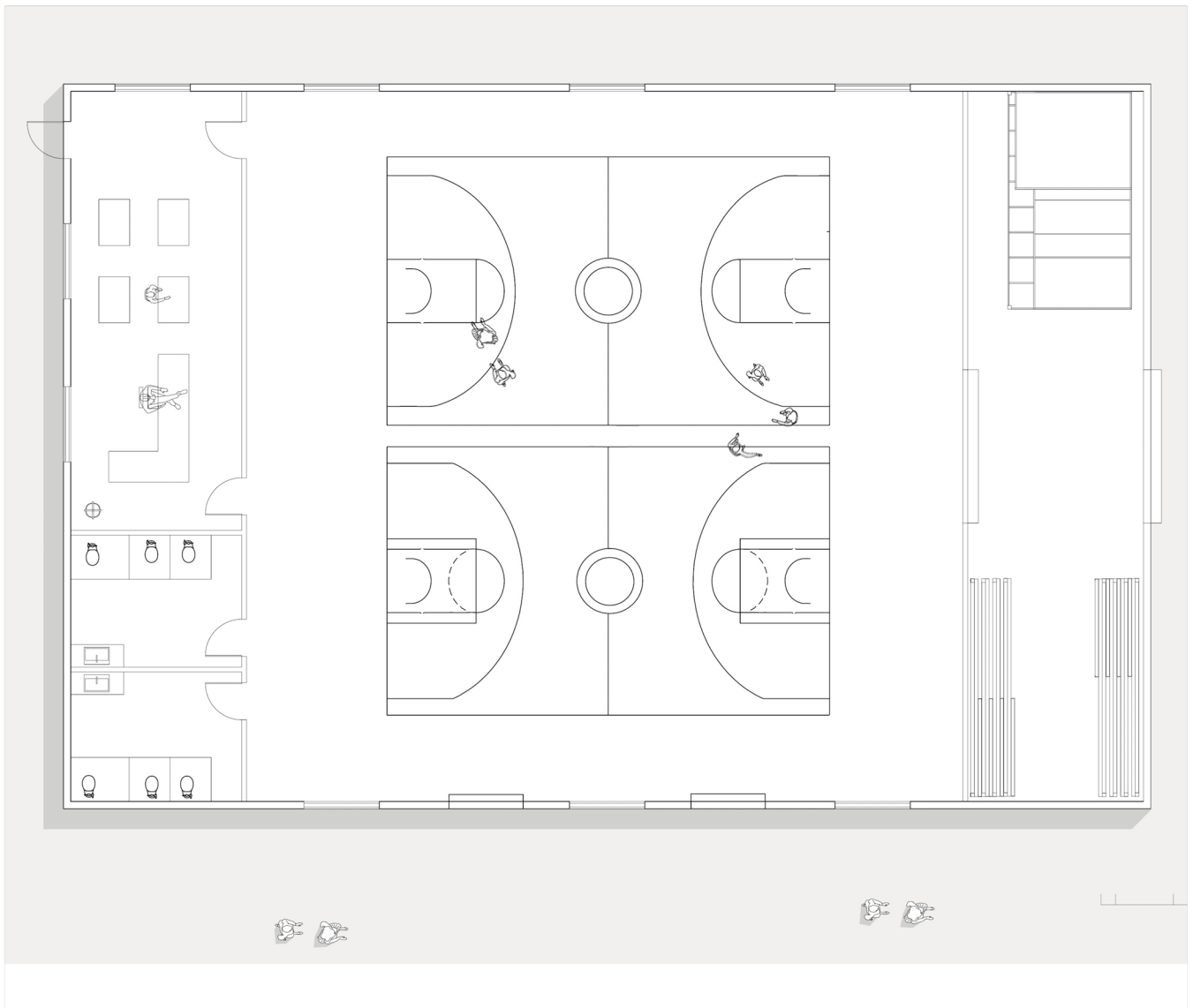

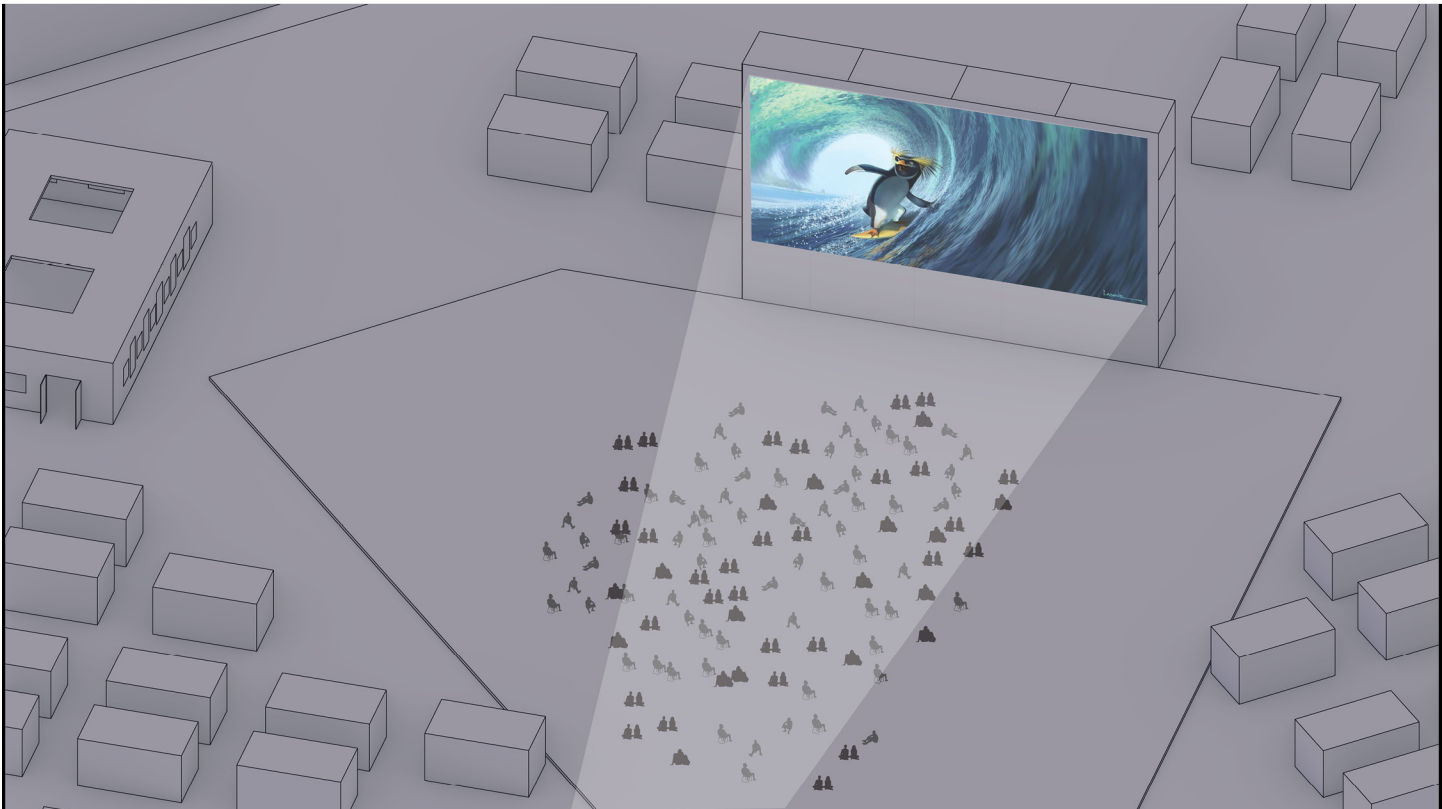
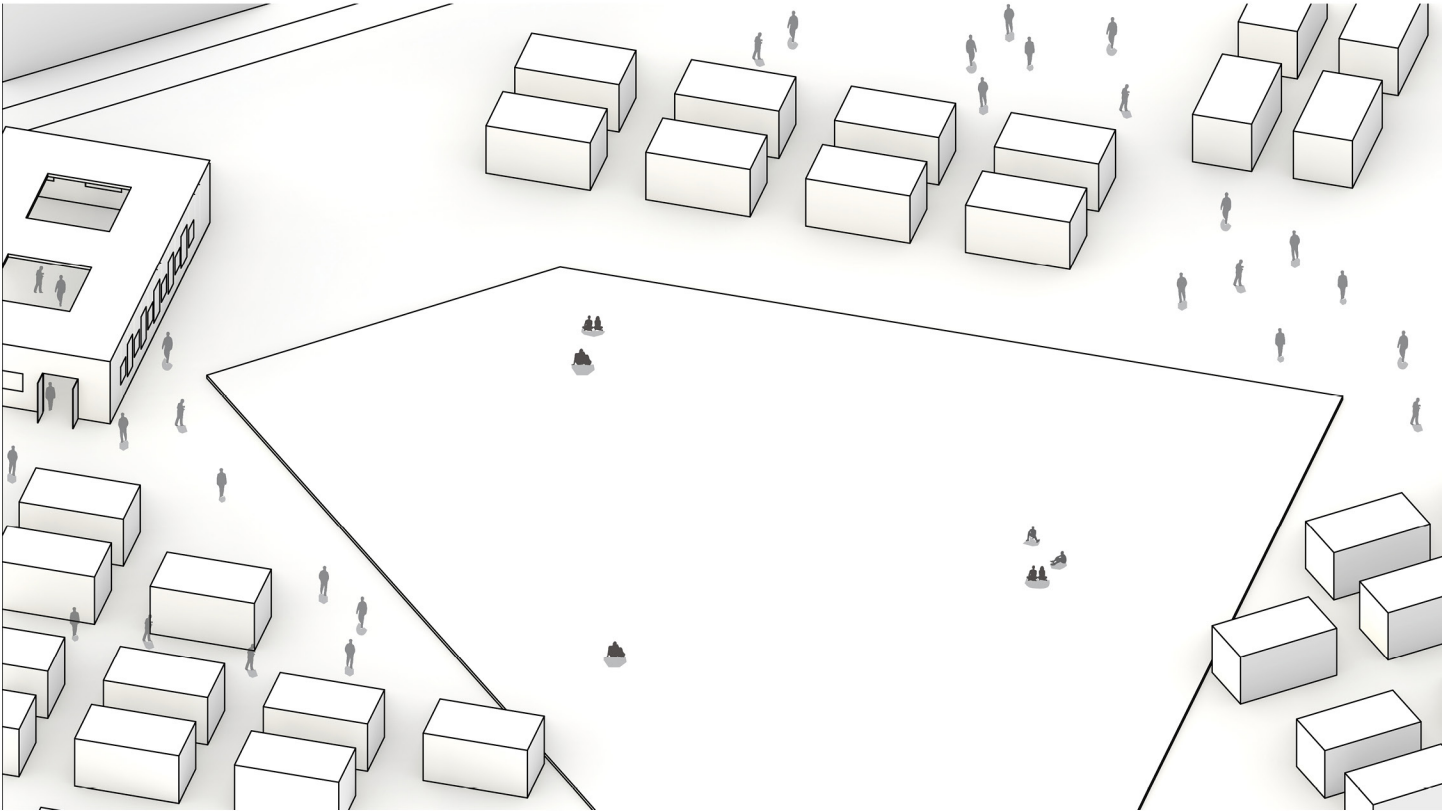

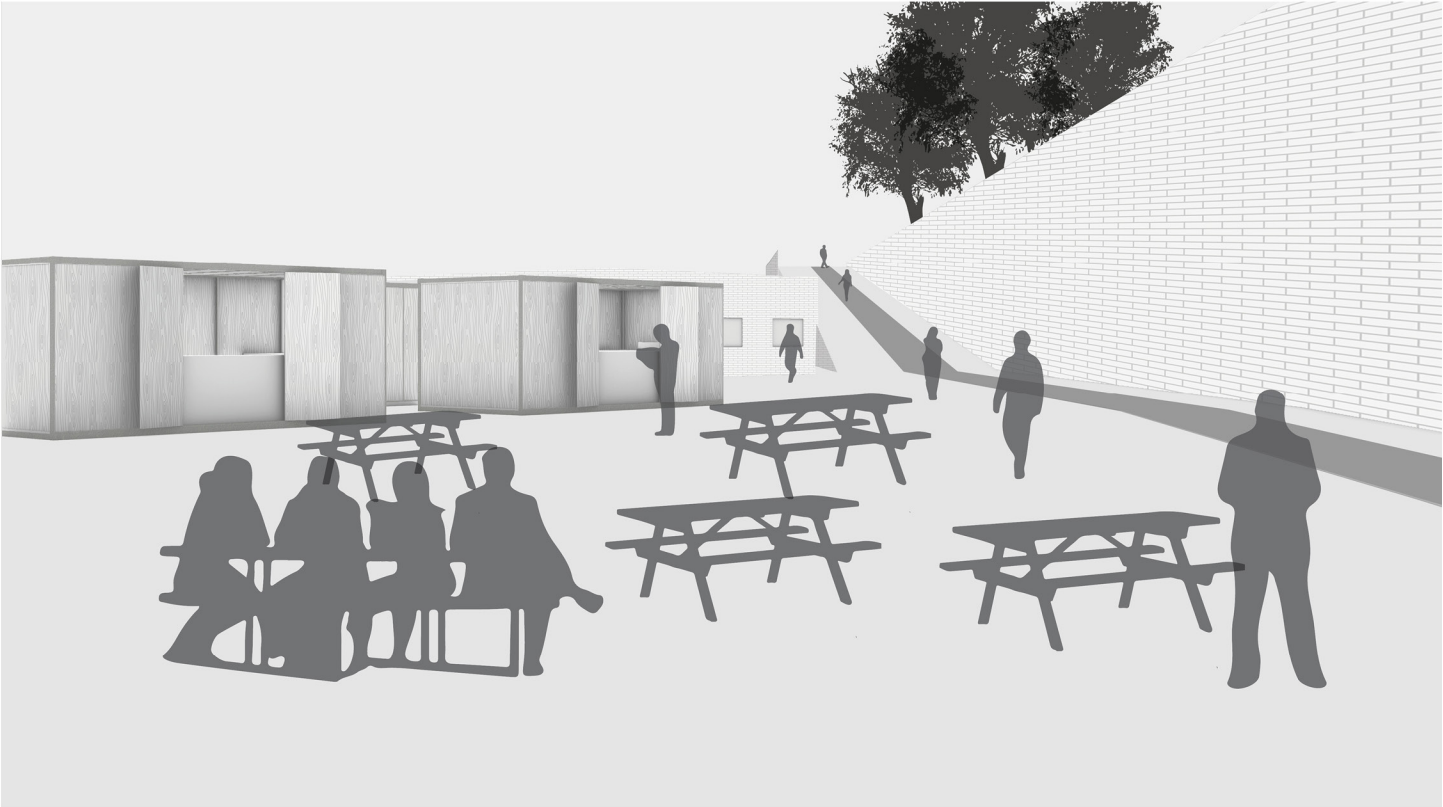



Onondaga Lake Community Center

This project aims to clean the top side of the lake. The project is a cultural center that showcases some Native American history, as well as the nature of the region, mainly aquatic, both plants and animals. The plants become the exhibition as well as the objects in the main building. The plants grow on a frame that overtime becomes more opaque as you can walk on the plant surface. In the beginning the project starts as a frame with a series of pot-like areas and wood platforms to walk on, eventually growing plants above and below water over time to create a permanent and natural space.

Produced for ARC 208 - Sou Fang

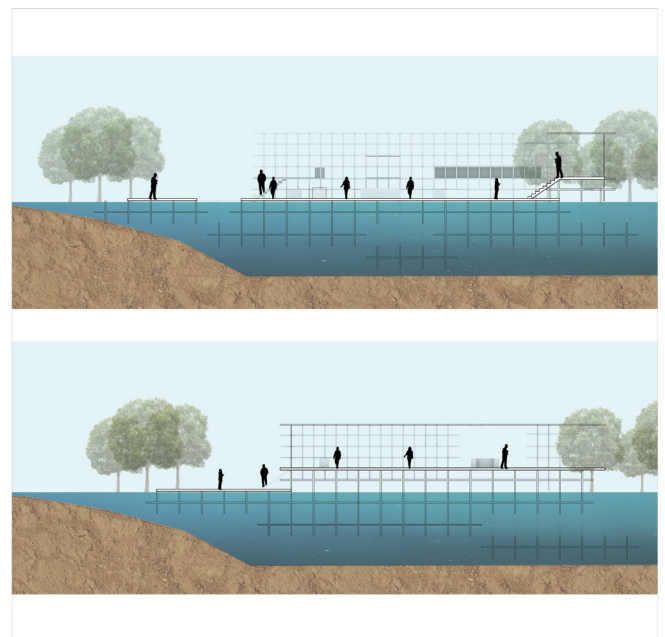
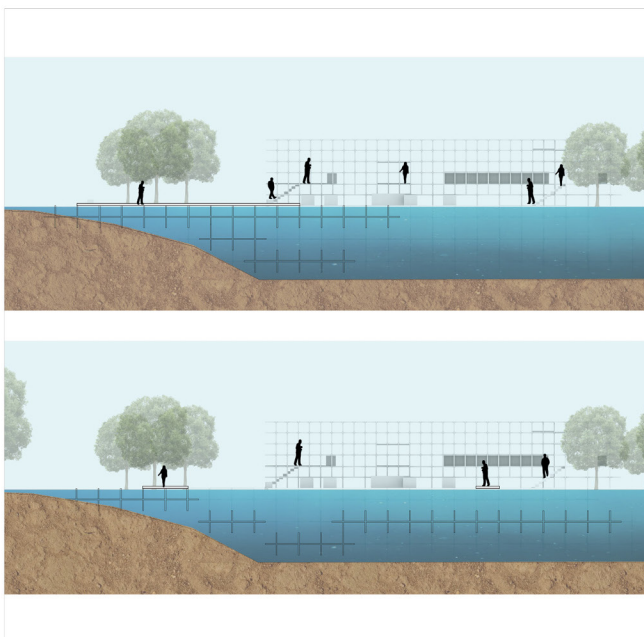
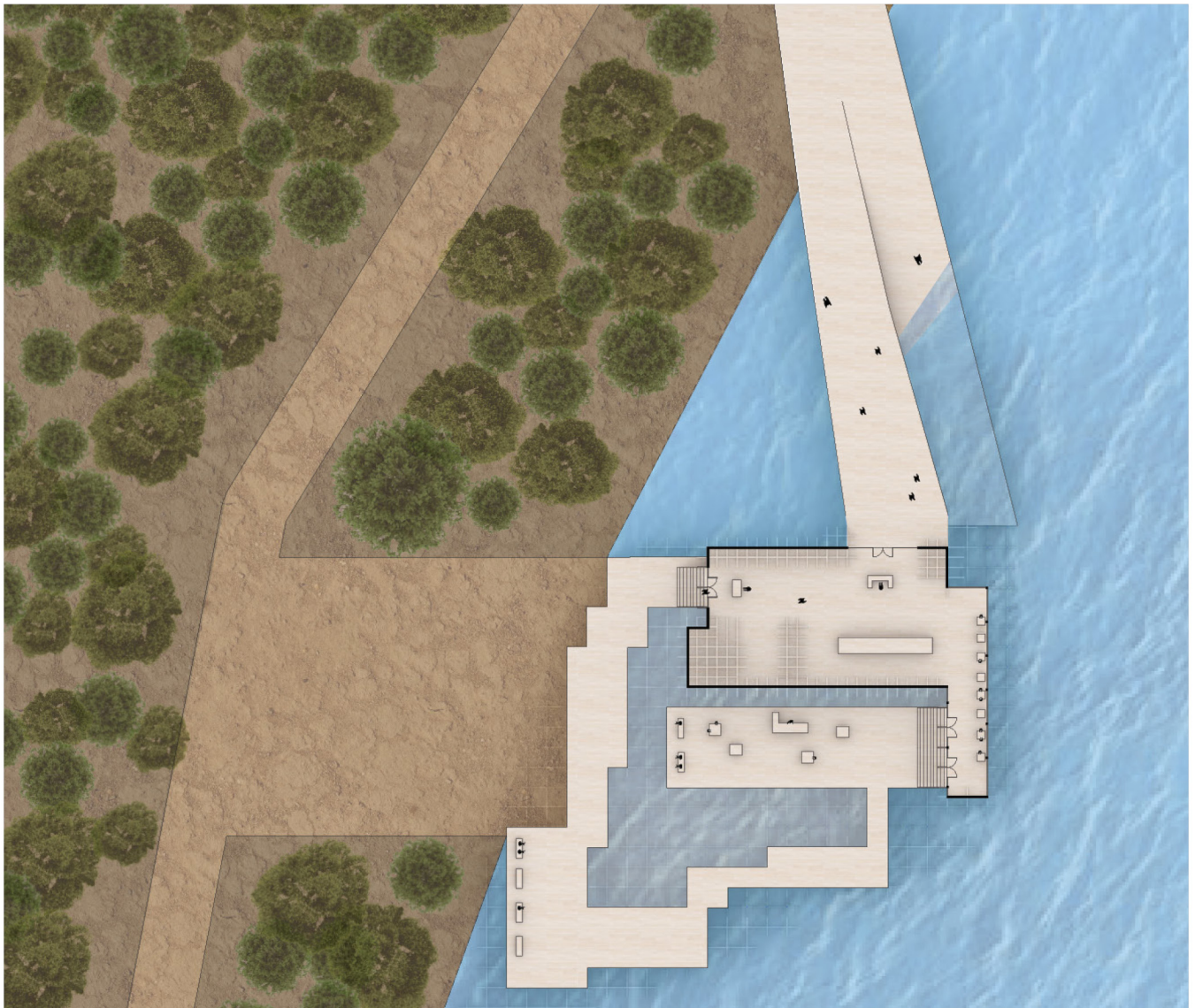

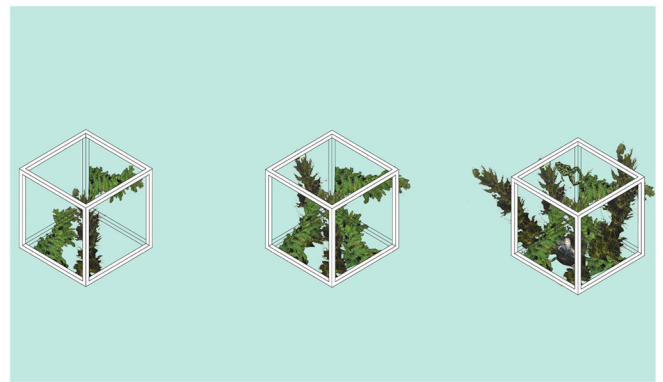
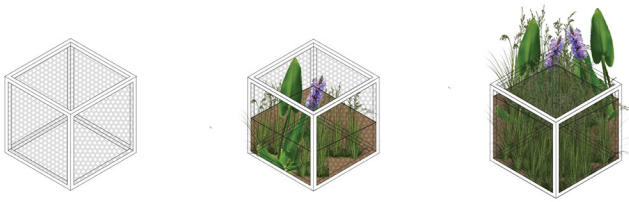
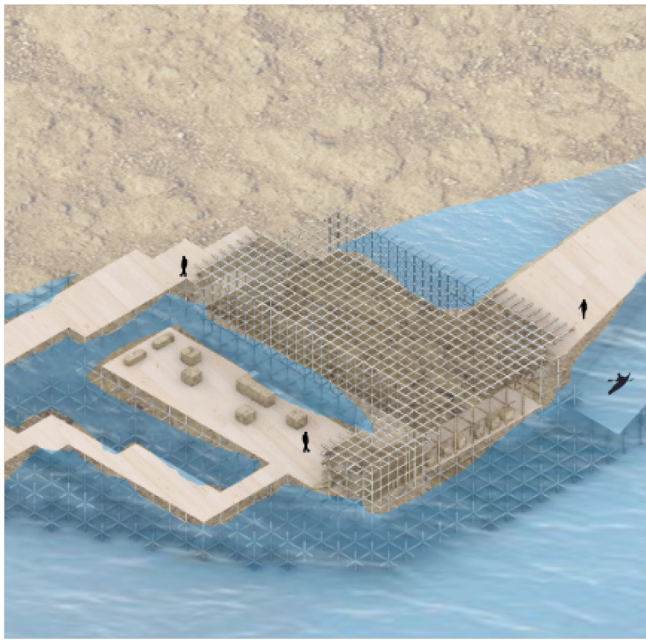

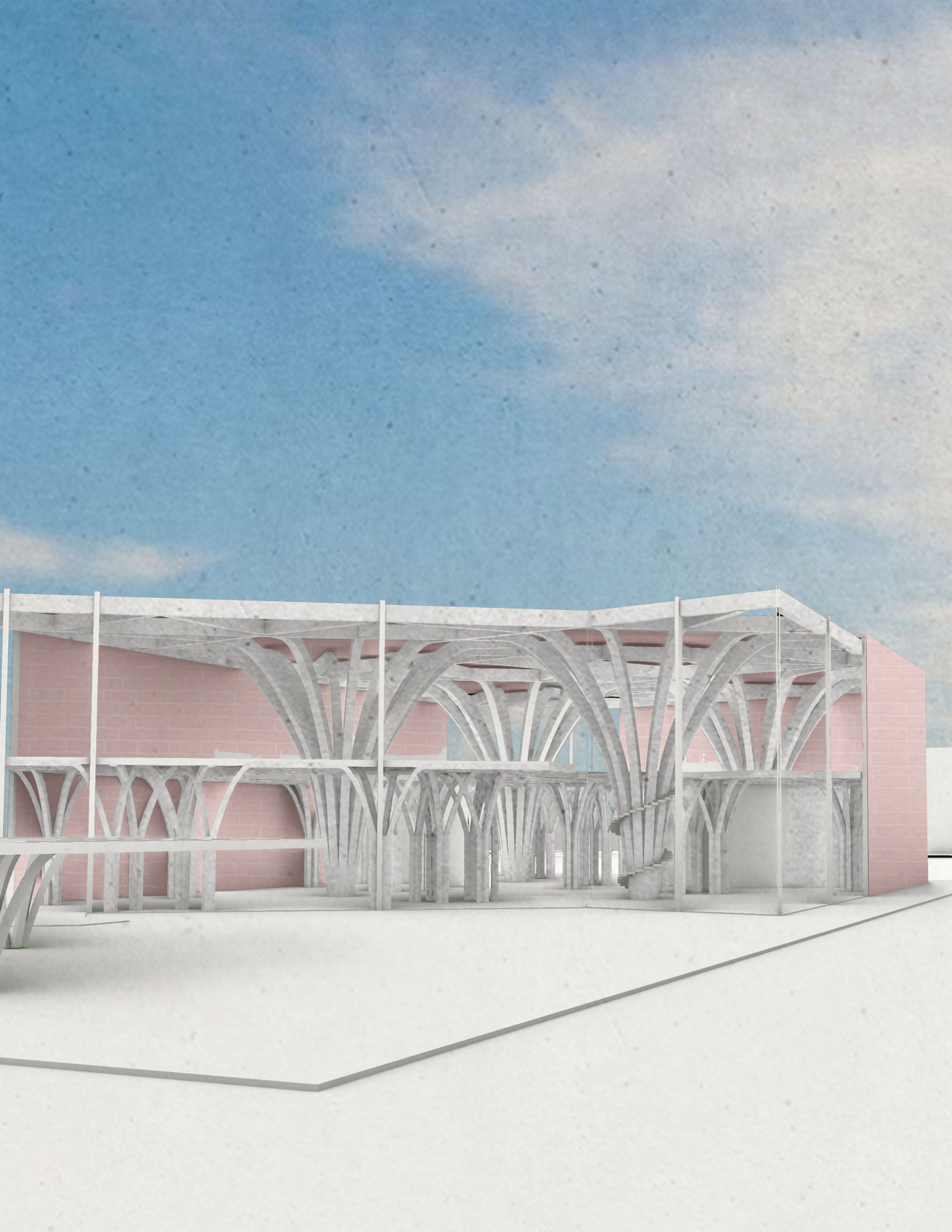

Forest of Columns

A converted warehouse turned into a signage factory. This project takes inspiration from the original warehouse and modifies it. The heavy columns from the previous building morph into beautiful shapes from the old bays.

Produced for ARC 207 - Hannibal Newsom

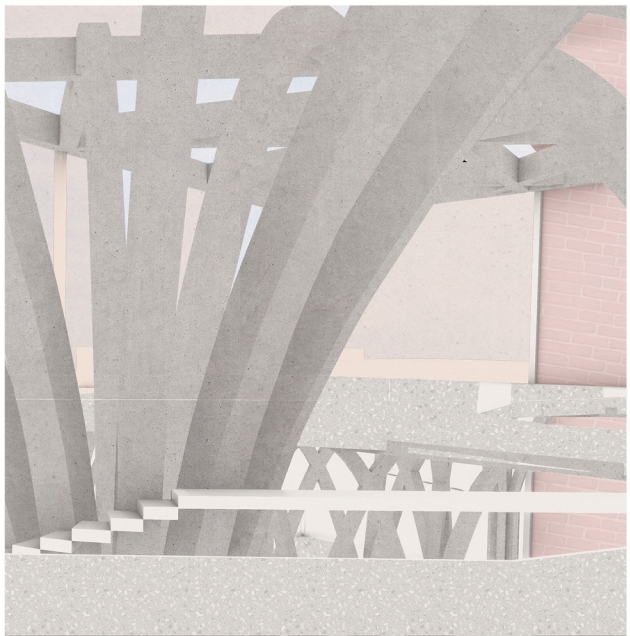
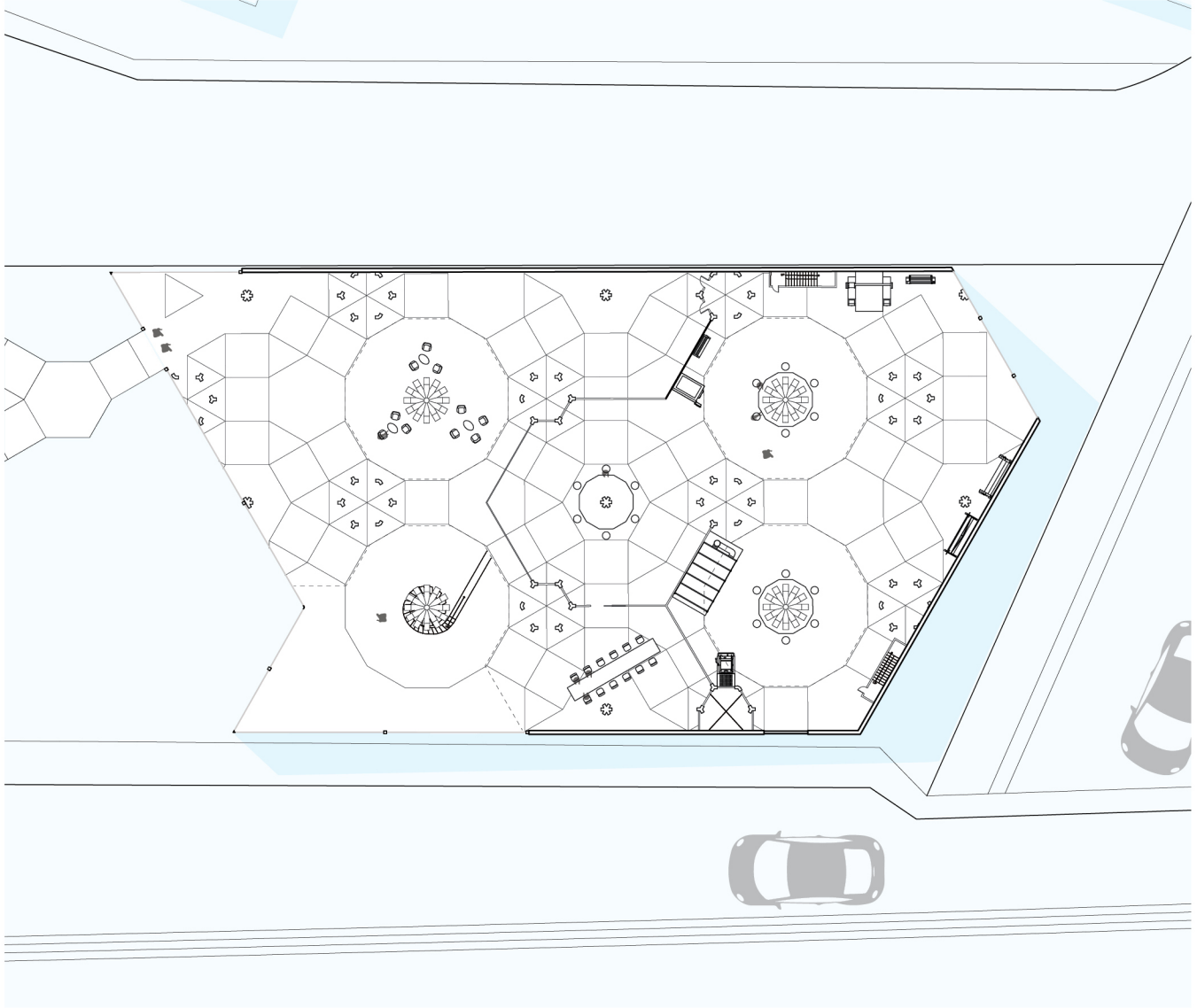

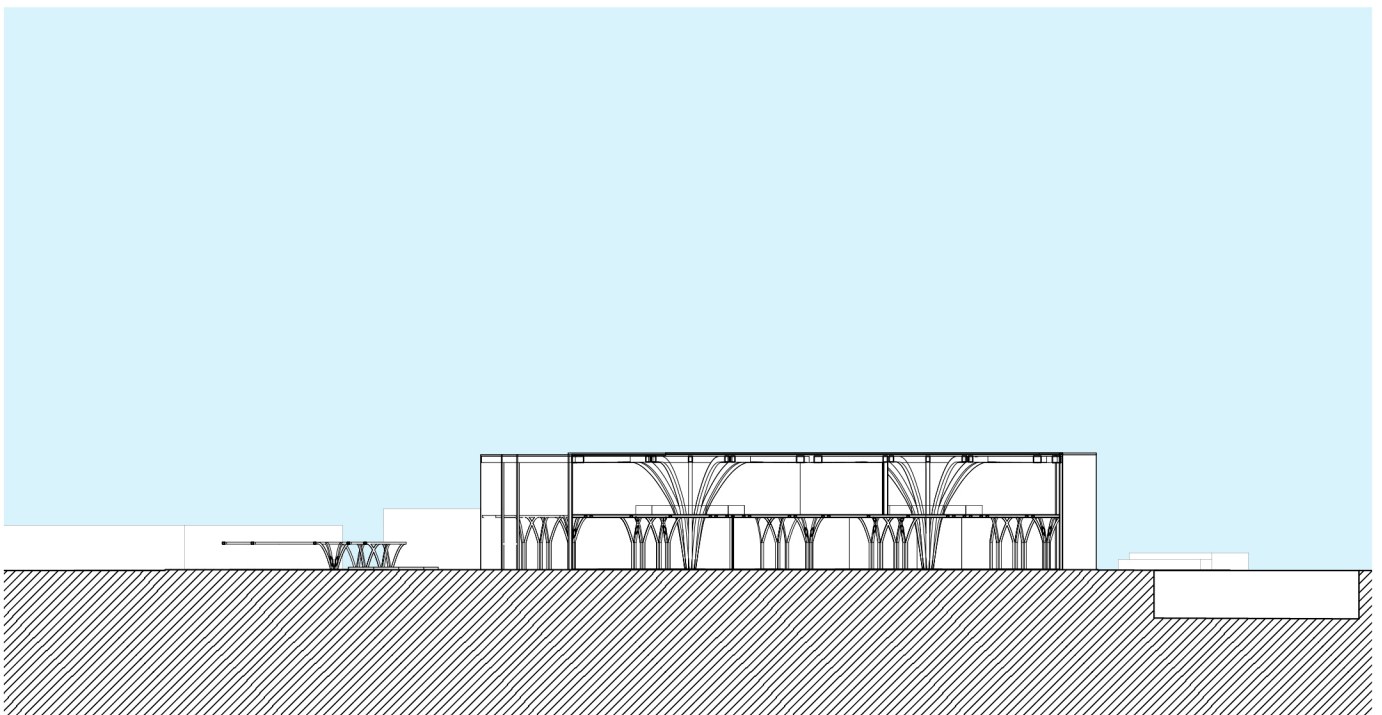

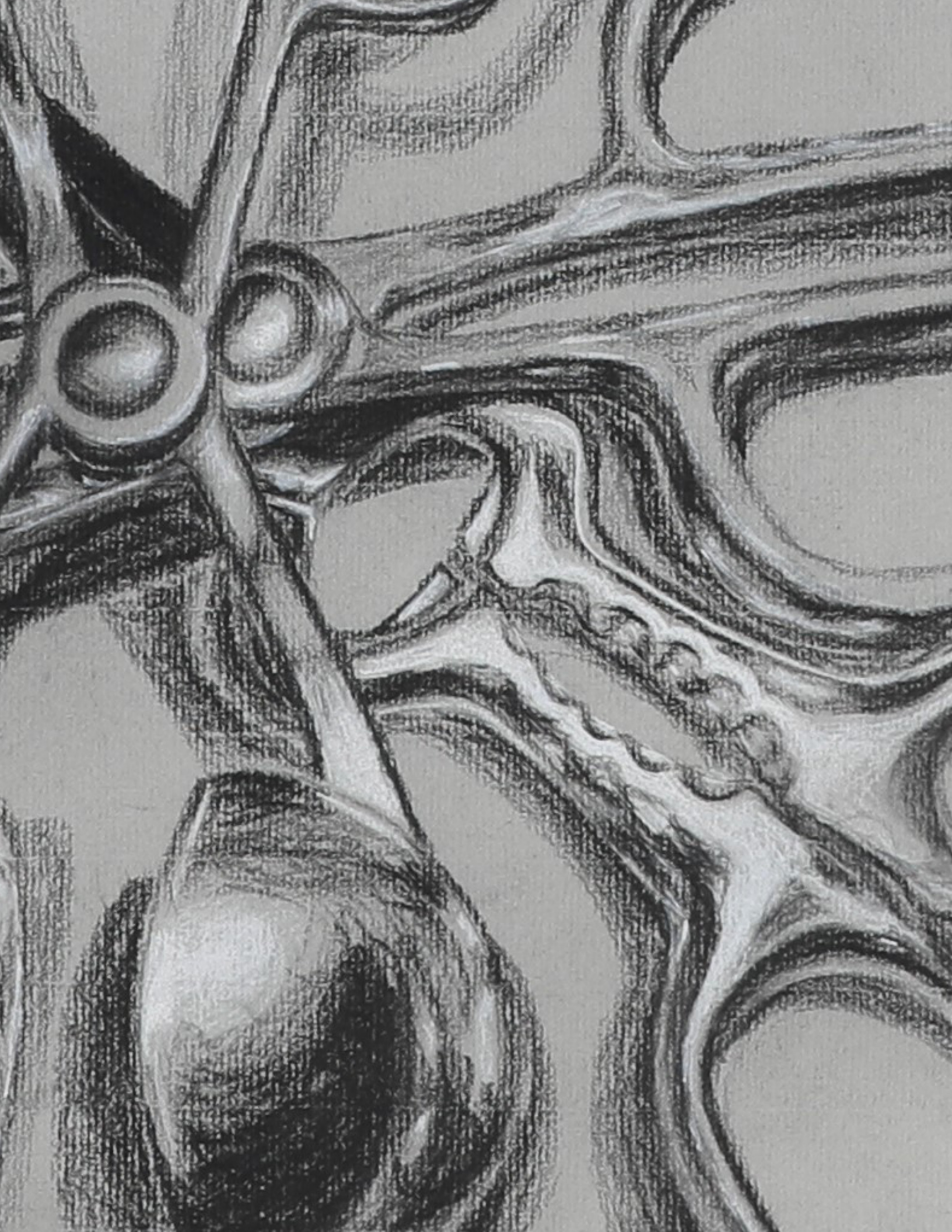

Additional Work

Models, Art, and Graphic Design

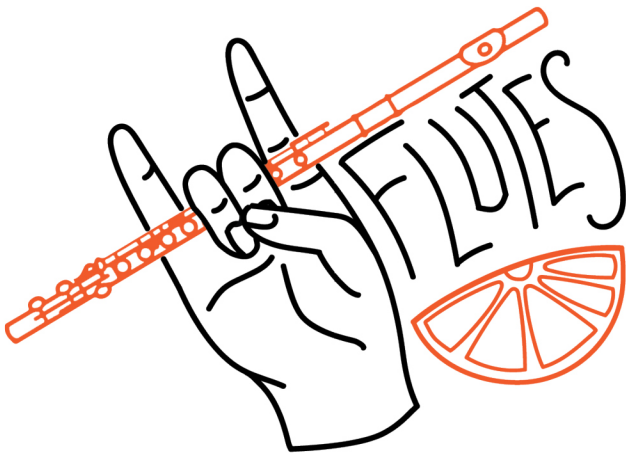

BOTW Recipes: Ranked

First Course		meaty riceballs mushroom rice balls seafood riceballs veggie riceballs vegetable curry poultry curry seafood curry meat curry curry rice	
Second Course		mushroom risotto salmon risotto vegetable risotto salt-grilled salmon salt-grilled mushrooms salt-grilled crab salt-grilled meat steamed mushrooms steamed fruit salt-grilled greens crab risotto steamed fish steamed meat	
Third Course		honeyed apple honeyed fruits glazed veggies glazed meat wildberry crepe honey crepe clam chowder plain crepe glazed mushrooms meat-stuffed pumpkin pumpkin stew meat stew carrot stew glazed seafood	
Fourth Course		wheat bread mushroom omelet fried egg crab omelet with rice omelet vegetable omelet fragrant mushroom saute herb saute creamy seafood soup creamy meat soup cream of mushroom soup cream of vegetable soup veggie cream soup crab stir-fry	
Fifth Course		creamy heart soup pepper steak fruit pie meat pie pumpkin pie fish pie spicy peppered seafood honey candy apple pie spiced meat skewer egg tart	
Sixth Course		fried bananas poultry pilaf meat and rice bowl curry pilaf hot buttered apple nutcake seafood paella seafood meuniere carrot cake porgy meuniere seafood fried rice spicy meat and seafood fry salmon meuniere meat and seafood fry fruitcake fruit and mushroom mix egg pudding	

Best Dish

Wheat Bread



Worst Dish

Egg Pudding



Transcendent



Full Heart



Half Heart



Empty Heart



Negative Heart

Disclaimer:

Every recipe was created using the least amount of ingredients possible and only the ingredients specified in game (including salt and pepper). Carrots were used in place of most vegetables, this in no way affected the flavor of any dishes.

Try at your own risk, these dishes may or may not affect your own health.



